



# Bure™ XL

## StandTall Walker



# Bure™ XL

## StandTall Walker

**Bure XL** is designed for the bigger, heavier patient and therefore provides extra space and strength. Because extra powerful aids are required in the care and nursing of heavier patients, **Bure XL** is always supplied with electric drives.

### Ergonomic handles

The ergonomically designed handles are steplessly adjustable in every direction for optimum individual adaptation. This is extremely important for stroke patients who can thus reach their "usual" hand position.

### Easily reachable hand controls

The hand controls are located such that both of the carer's and user's hands can easily reach them.

### Power Rise

Bure XL provides excellent assistance when helping patients and users stand. The physical burden on staff, and in turn the risk of repetitive strain injury, is minimised. Depending on their current condition, a number of patients are even able to stand up by themselves using the power rise feature.

### Open design

The open design provides the same stability but with greater room for manoeuvre. The patient does not feel shut in and it makes assistance with standing up and dressing easier.

### Water proofing

All Bure XL electrical components have IP 65 international protection ratings and can occasionally be used in damp areas.

### Sustainable

The StandTall Walker is designed to last a long while. For example it has an extra reinforcement band around the armrest cushions to prevent splitting from side impacts.

### Stable

The StandTall Walker has anatomical cushions that provide relief for shoulders, arms and the neck and shift the focus to larger muscle groups such as leg and chest muscles instead. This improves stability and makes the walker easier to steer.

### Flexible stepless adjustment

Electrically driven height adjustment makes it easy to preset the StandTall Walker to the desired height. Once the patient is standing in position the height can be steplessly adjusted for best comfort and optimal walking support.

### Designed for weight

The Bure XL is designed to provide support for heavier patients who weigh up to 240 kg. This StandTall Walker has also been widened to provide good stability and plenty of space. The inner dimension is 44–62 cm. The extra legroom makes it especially easy for patients who need extra walking space due to e.g. leg spasms.



## Technical specifications

Dimensions apply to walkers with 125mm castors

CE marked according to MDD 93/42/EEC

Product Code	Product	Width	Max user weight	Length	Height	Armrests/internal dimension
RHGA-56-315	Bure XL - Electric	88cm	240kg	78cm	91-131cm	44-62cm

## Accessories



### Brake Kit Twin

Adds a hand brake so that the user is able to halt movement during walking exercises.  
**RHGA-56-315-0**



### Platform Steel

A flexible alternative when moving a patient a short distance.  
**RHGA-56-386**



### Drip Stand with Attachment

Creates great ability for a patient to move freely in a room, on the ward or at home.  
**RHGA-56-338**



### Oxygen Bracket

Means that a patient is no longer confined to the bed.  
**RHGA-56-336**



### Side Support

Prevents arms from sliding from armrest cushions and stabilise walking.  
**RHGA-56-337**



### Soft Basket

Basket with attachment has enough room for all the important stuff.  
**RHGA-56-389**



### Stirrup

Stand Tall Walker Part/Accessory:  
Stirrup (Suitable for all models except for BURE DOUBLE)  
**RHGA-56-331-1**



### Castors with brake (various sizes)

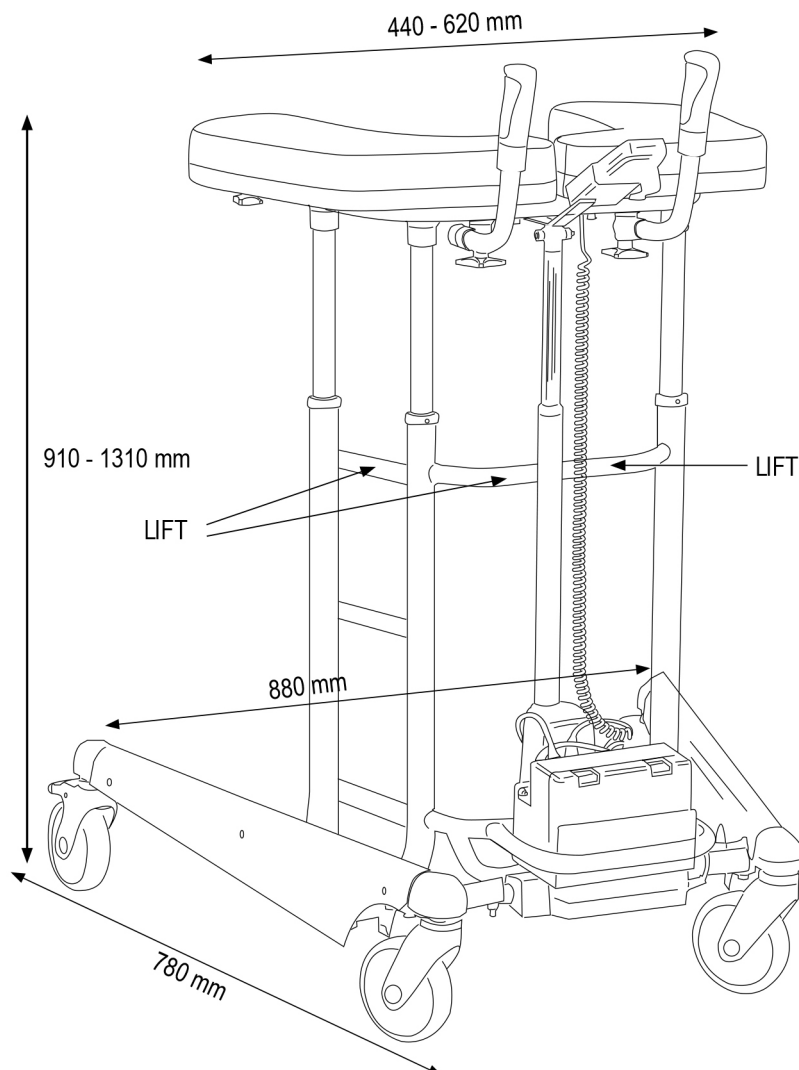

SHI070115-v2.1

## Improved general condition

Apart from being an excellent aid for getting patients up and about, the Stand-Tall Walker is also a valuable rehabilitation tool. Rehabilitation using the StandTall Walker keeps the patient's muscles and alimentary canal active and contributes to improving the general condition of the otherwise bedridden.

Proper support makes it easier for infirm patients or those with weak legs to walk, and some can even manage without the support of healthcare personnel.

## Improved work ergonomics

The Bure StandTall Walker creates opportunities for much better work ergonomics for carers, trainers and anyone working with patients. For example, the open design provides increased manoeuvring space and makes access easier when getting up or dressing. The Bure StandTall Walker contributes to reduced workloads and is an investment in personnel health.

## Enhanced stability

Bure has anatomically designed cushions at a slight incline that help shoulders and arms to relax. The Stand-Tall Walker's design helps to shift the focus from muscles in the hands, arms and shoulders to larger muscle groups such as leg and chest muscles. Stability is improved and the walker is easier to steer at the same time as trunk bending is cushioned and posture improved.



## Other Walkers in the Bure™ StandTall range



**Bure™**  
Double Stand Tall Walker

**Bure Double** is GATE's most advanced, flexible StandTall Walker. It is equipped with twin electric drives for raising and lowering the table and widening the walking frame.



**Bure™**  
Ortho StandTall Walker

**Bure Ortho** is especially designed for orthopaedics departments and situations that demand extra legroom and room for manoeuvre for the user. **Bure Ortho** has a powerful electric motor for powered height adjustment.



**Bure™**  
Standard/S  
StandTall Walker

**Bure Standard** and **S** is available in three versions; ELECTRIC, GAS and MANUAL. **Bure S** is a support walker and a narrower version of the **Bure Standard** specially adapted to work in confined spaces and to perform flexibly in every situation.

## Also Available



**Bure™**  
Rise & Go™

**Bure Rise & Go** is an all-round solution that saves space, time and money. Instead of purchasing both hoists and walkers it is probably often sufficient to acquire the flexible, cost effective **Bure Rise & Go**.



**Amfibi™**  
Hygiene Chairs

**GATE hygiene chairs** are available in three different versions. **Amfibi Double** is the most advanced, versatile hygiene chair; it is adjustable in height and tilt angle of inclination. **Amfibi XL** was designed for the bigger, heavier patient, while **Basic** is the simplest version.



Distributed by:

For more information, or to find your nearest dealer, call us on 1300 791 404 or visit [www.gaterd.com.au](http://www.gaterd.com.au)

