



Amfibi™ Double

Hygiene Commode



Amfibi™ Double Hygiene Commode

Amfibi Double is GATE's most advanced and versatile hygiene chair. It is equipped with twin electric drives, electrically operated raising and lowering and electrically operated tilt. The chair can be adjusted steplessly even when the patient is in the chair. Together with the soft, relaxing relief offered by the seat and back, the chair's functions provide superlative comfort for the patient and a minimum of strain for personnel.

Tilt function

Amfibi Double can be inclined 5 degrees forward to 25 degrees rearward. This makes it easy to use for personal hygiene and when sitting down or getting up. The tilt function also improves the working environment and reduces strain on personnel.

Ergonomic seat

The Amfibi Double's seat is adapted for an upright posture that does not close the pelvis. It minimises pressure and is designed to suit both men and women. The seat is easy to remove and clean, while its rounded front edge contributes to a comfortable leg position.

Plastic or metal

A guide is available for Amfibi as an accessory. Note that the guide is available in different versions to suit plastic or metal bedpans. See *accessories*.

Swing-away, detachable footrests

An infinitely variable seat height from 53 all the way to 82 cm means the chair will fit every patient and reduce staff workload to a minimum.

Individual fit

Amfibi Double has a neck support that is adjustable in height and depth for comfortable support and individual fit.

Easy control

Simply press the remote up/down and tilt buttons to operate. The cabled remote is sealed to a high protection class (IP66).

Adjustable backstrap

The soft, comfortable backstrap relieves pressure on bony areas. It is easily adjustable for best support and seat depth. Machine washable.

Lockable armrests

The armrests can be flipped up and locked in position to make it easier for the patient to assist with the transfer.

Ergonomics

The chair liberates the user from effort completely, while no manual exertion is required on the part of the carer during any of the manoeuvres.

Durable materials

Manufactured from corrosion-proof materials.

Lockable castors

All four castors are lockable.



Technical specifications

Dimensions apply to walkers with 125mm castors

CE marked according to MDD 93/42/EEC

Product Code	Product	Width	Max user weight	Seat Depth	Seat Height	Armrests/internal dimension
RHGA-56-203DB	Amfibi Double	62cm	150kg	45cm	53-82cm	52cm

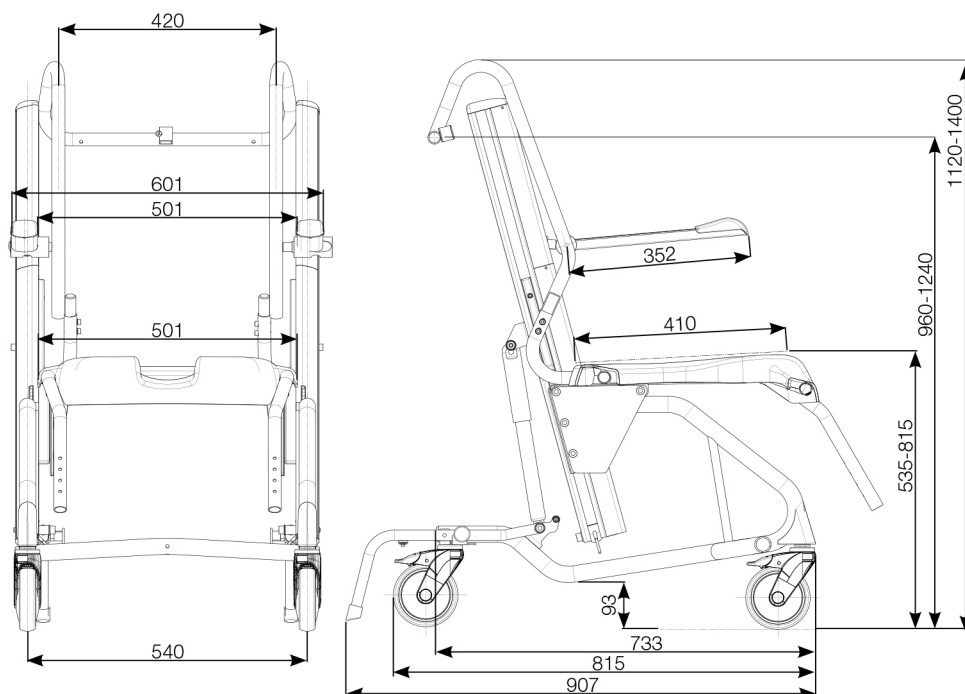

Accessories



Soft Seat
RHGA-56-206



Heel Loops
RHGA-56-220



Safety Bar for DB
RHGA-56-212-DOUBLE



Side Supports
RHGA-56-216



Splash Guard
RHGA-56-213



Waste Container
RHGA-56-209

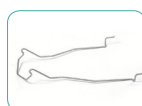

Waste Container Holder
RHGA-56-218



Safety Belt Hip
RHGA-56-217



Safety Belt Chest
RHGA-56-229



Amputee Support
RHGA-56-228-L/R



Calf Support
RHGA-56-227-L/R



Footrest
RHGA-56-257-L/R



Calf Strap
RHGA-56-225



Castors with brake
(various sizes)

SHI200115-v2.3

Designed to meet needs

GATE hygiene chairs have a unique pillar design for quick and easy seat height adjustment. There is a choice of manual or electric adjustment to suit various needs. Amfibi fits most people no matter how tall, and staff will not need to waste time and energy looking for a suitable hygiene chair for each situation.

Everyday life improved

And it goes without saying that Amfibi never compromises on user comfort and personnel ergonomics. Individually adaptable comfort and function makes the hygiene chair a much more

pleasant experience for patient and healthcare staff alike. Amfibi is manufactured from corrosion-proof materials and its actuator can withstand high pressure hot water (IP66).

Best possible comfort

Users often sit in a chair for a long while when washing or taking a shower, and this can become very trying. Amfibi was created to provide extremely high comfort. The seated Amfibi user is able to assume a position for the best possible comfort. The hygiene chair quickly adapts to a personal fit with the aid of easily operated settings, and all models are height-adjustable.

The Amfibi's seat and back are adapted for an upright posture that does not close the pelvis. The ergonomic design minimises pressure on the hips, tendons and blood vessels, while its rounded front edge contributes to a comfortable leg position. The new, soft, water-repellent backrest that provides the best possible comfort and hygiene is unique to Amfibi (accessory). It is easily adjustable for best support and seat depth.

GATE hygiene chairs are available in three different versions. Amfibi Double is our most advanced, versatile hygiene chair; it is adjustable in height and tilt angle of inclination. Amfibi XL was designed for the bigger, heavier patient, while Basic is our simplest version.

Other Commodes in the Amfibi™ range



Amfibi™
Basic Hygiene Commode

Amfibi Basic was developed to meet most basic needs. With its attractive price it provides a lot of hygiene chair at low cost. **Basic** has adjustable seat height and a wide range of accessories that make it easy to individually adapt the chair to suit every patient's needs.



Amfibi™
XL Hygiene Commode

Amfibi XL was designed for the bigger, heavier patient and therefore provides extra space and strength and electrical height adjustment. Maximum user weight is 250 kg.



Amfibi™
Double HighBack
Hygiene Commode

Amfibi Double HighBack is a further development of our much appreciated Amfibi concept. It is equipped with a high, upholstered back with upholstered back including neck rest and integrated seat with rear opening.

Also Available



Bure™
Rise & Go™

Bure Rise & Go is an all-round solution that saves space, time and money. Instead of purchasing both hoists and walkers it is probably often sufficient to acquire the flexible, cost effective **Bure Rise & Go**.



Bure™
StandTall Walkers

Apart from being an excellent aid for getting patients up and about, the **StandTall Walker** is also a valuable rehabilitation tool. Rehabilitation using the **StandTall Walker** keeps the patient's muscles and alimentary canal active and contributes to improving the general condition of the otherwise bedridden.



Distributed by:

For more information, or to find your nearest dealer, call us on 1300 791 404 or visit www.gaterd.com.au

